

IGS204

IGB3008BBPKG/US-104

Inductive sensors

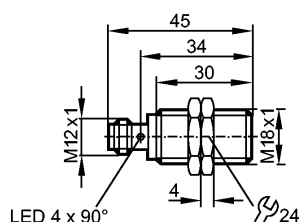

Product characteristics

Inductive sensor

Metal thread M18 x 1

Connector

Increased sensing range

Gold-plated contacts

Sensing range 8 mm; [f] flush mountable

Electrical data

Electrical design	DC PNP
Operating voltage [V]	10...30 DC
Current consumption [mA]	< 10
Protection class	II
Reverse polarity protection	yes

Outputs

Output function	normally open
Voltage drop [V]	< 2.5
Current rating [mA]	100
Short-circuit protection	yes
Overload protection	yes
Switching frequency [Hz]	400

Range

Sensing range [mm]	8
Operating distance [mm]	0...6.5

Accuracy / deviations

Correction factors	mild steel = 1 / stainless steel approx. 0.7 / brass approx. 0.5 / Al approx. 0.4 / Cu approx. 0.3
Hysteresis [% of Sr]	3...15
Switch-point drift [% of Sr]	-10...10

Environment

Ambient temperature [°C]	-25...70
Protection	IP 67

Tests / approvals

EMC	EN 61000-4-2 ESD: 4 kV CD / 8 kV AD EN 61000-4-3 HF radiated: 10 V/m EN 61000-4-4 Burst: 2 kV EN 61000-4-6 HF conducted: 10 V EN 55011: class B
MTTF [Years]	1528
UL approval number	A003

IGS204

IGB3008BBPKG/US-104

Inductive sensors

Mechanical data	
Mounting	flush mountable
Housing materials	Brass white bronze coated; active face: PBT orange; LED window: PEI; lock nuts: Brass white bronze coated
Weight [kg]	0.043

Displays / operating elements	
Output status indication	LED 4 x yellow

Electrical connection	
Connection	M12 connector; Gold-plated contacts

Wiring

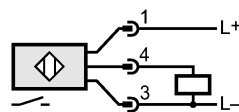
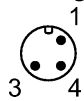

Accessories	
Accessories (included)	2 lock nuts

Remarks	
Pack quantity [piece]	1